

OCEANIC R

A unique recess mounted Architectural line luminaire with high efficiency diffuser for optimum performance and lighting balance

- Soft light with acrylic diffuser
- Housing material is extruded aluminum
- Easy installation and maintenance
- Easy integration with different application choice of suspended and recessed variants



INDOOR LIGHTING

LINEAR LIGHT

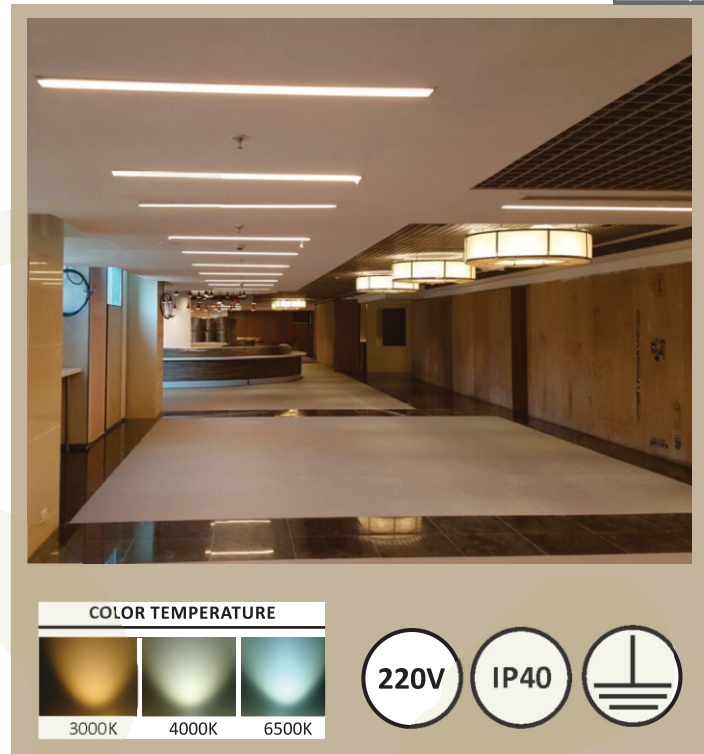

Housing: Oceanic R body is made of extruded aluminium. Proper integral heatsink, bezel matt finish for ceiling.

Optical: Diffused light produced with UV stabilised non yellowing PMMA, Good colour rendering LED downlight, choice of CCT 3000K-6500K at Ra>80,

Electrical: Oceanic R LED is available in varied wattages with PF>.95 & driver efficiency of >85%. Input power is 90-240VAC, 50Hz.

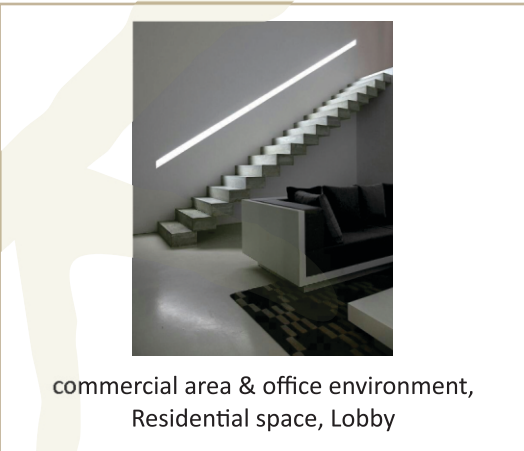

Product Name	Catalogue Reference No	Dimension	Lamp wattage	Lumen Output
OCEANIC R	VAK-CL-OCE-6535-1200-R18	65X35X1200	18W	1260
	VAK-CL-OCE-6535-1200-R36	65X35X1200	36W	2520
	VAK-CL-OCE-6535-2400-R36	65X35X2400	36W	2520
	VAK-CL-OCE-6535-2400-R72	65X35X2400	72W	5040
	VAK-CL-OCE-9035-1200-R18	90X35X1200	18W	1260
	VAK-CL-OCE-9035-1200-R36	90X35X1200	36W	2520